

Clungene[®]

Rapid Antigen Self-Test Nasal Swab

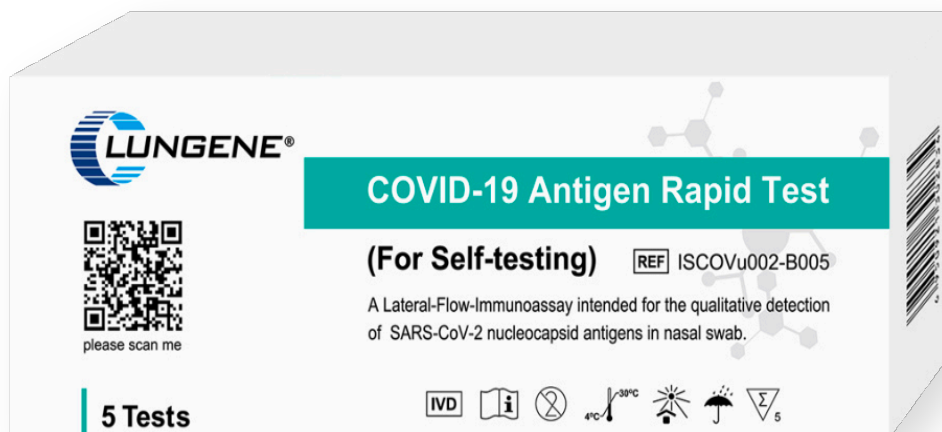

**The fast, easy and accurate
Rapid Antigen Self-Test**

TGA REGISTERED: 333341

- Available for immediate ordering
- High sensitivity (95.06%) and specificity (99.62%)
- Results available in 15 minutes

Product

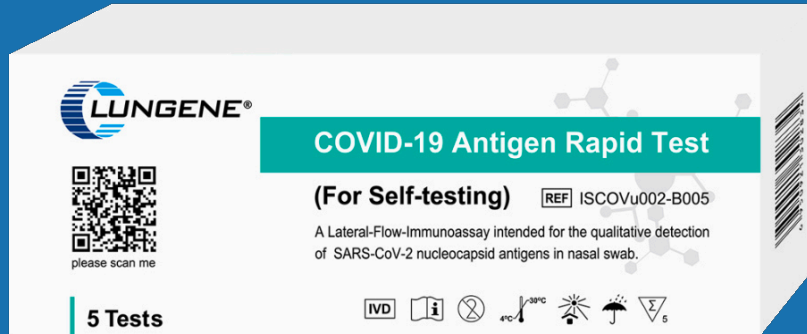





Specifications

Dimensions

5 tests per box

190 x 70 x 38mm

Test cassettes x5	Extraction nasal tubes x5	Swabs x5
		
Waste bags x5	IFU x1	
		

Packing Carton Information

Measure/Carton	Tests/Carton	Weight/Carton
59x40x58cm	1200 tests	21 kg

Test Procedure

Open the box, with the following contents



Instructions for Use

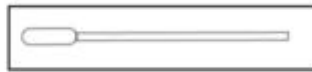

Swab

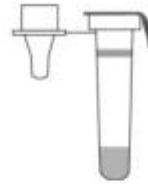

Extraction Reagent Tube



Test Cassette

Wash your hands with soapy water and dry thoroughly

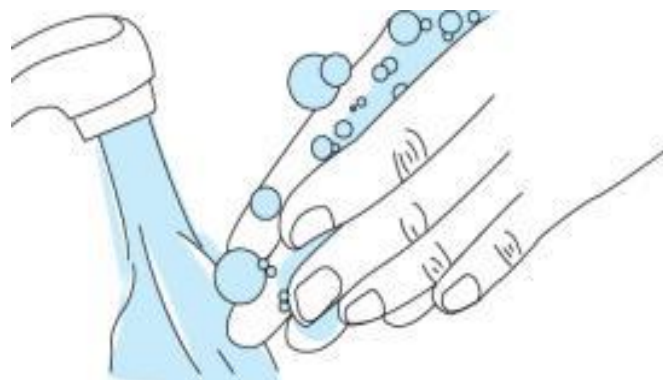

Step-by-Step Instructions

Open extraction reagent tube

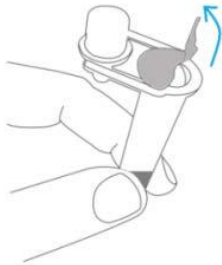

Insert tube into box

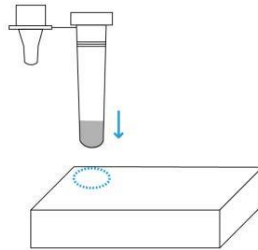

Remove the swab

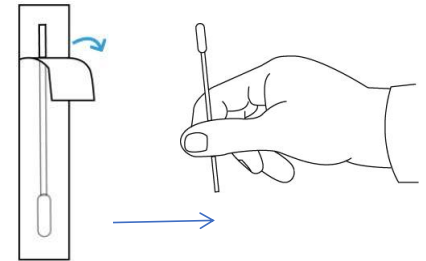

Swab the left nostril

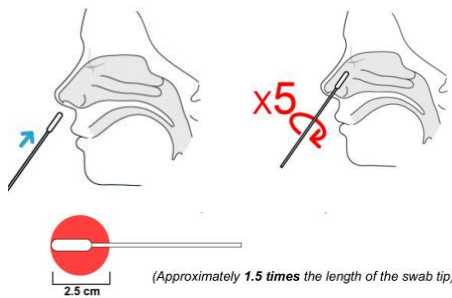

Swab the right nostril

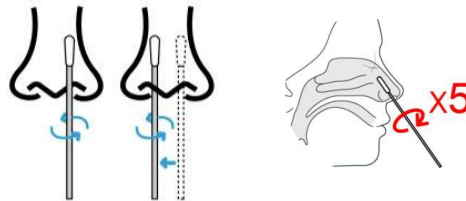

Insert the swab into the tube

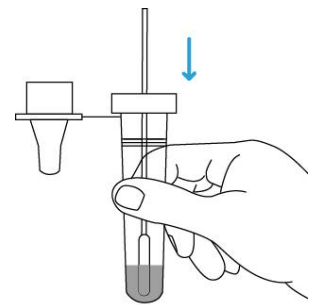

Rotate the swab 5 times

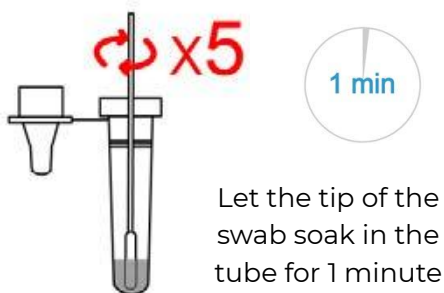

Remove the swab

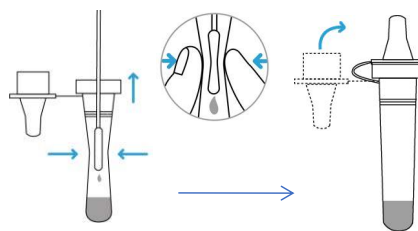

Take out the test cassette from the pouch

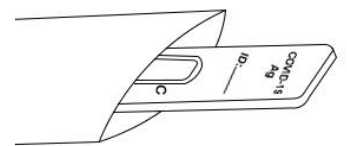

Add sample to the sample well

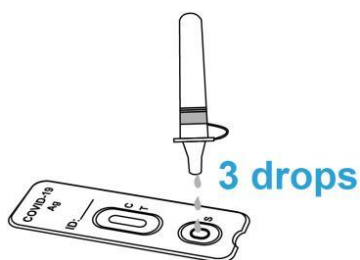

Start timer and wait 15 minutes.

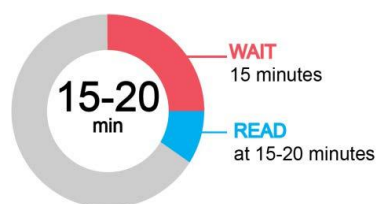

Read the test result at **15-20** minutes

DO NOT read the result after 20 minutes

Read Result

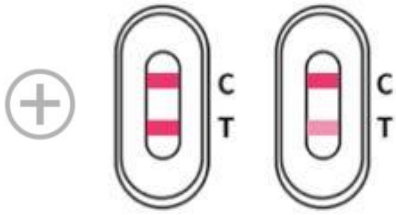

Positive Result

Two lines appear



Negative Result

One coloured line appears at the control region (C), and no line appears at the test region (T)



Invalid Result

Control (C) line fails to appear

Dispose of the Used Test Kit

Collect all parts of the test kit and place in a waste bag that can be placed in the general waste.

